

## Two-piece, floating ball valve 2"- 12" Class 150-300

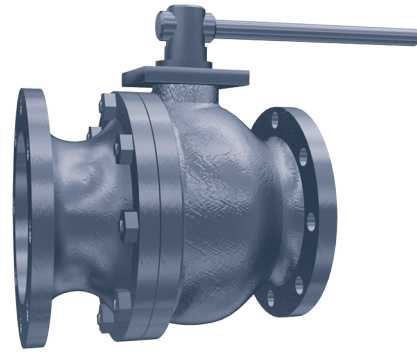

### DESIGN FEATURES

- Tightness is achieved by pressing the ball against the back seat.
- Anti-Static protection.

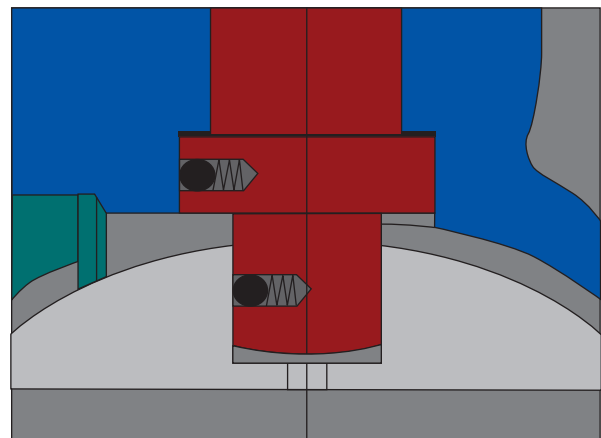
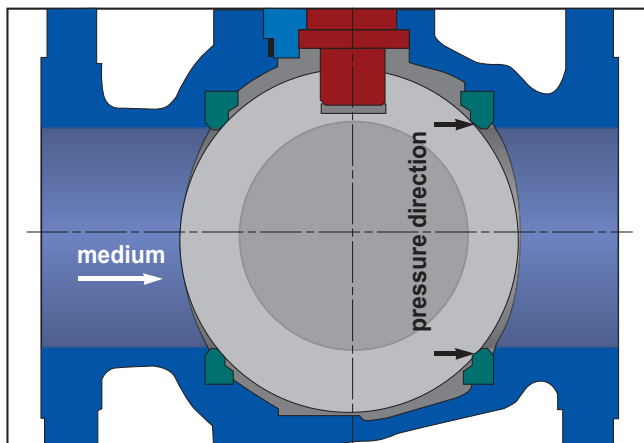

- Cost effective solution for low pressure ratings
- Easy maintenance, repair and trim accessibility due to split body design
- Seats design providing balanced pressure loads on the ball
- Guaranteed tightness provided by pressing the ball against the output seat using line pressure.
- Pressure relief system which is engaged when the line working pressure exceeds the specified threshold.
- Anti blow-out stem with antistatic design

## Two-piece, floating ball valve

### PARTS AND MATERIALS

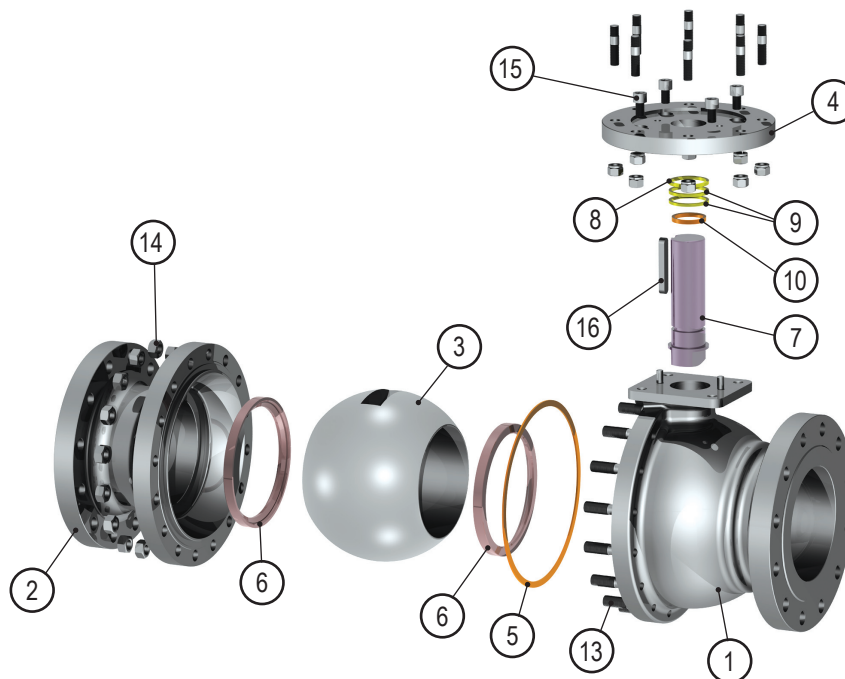

Number	Part	Standard	Low Temperature Service	Standard & Low Temperature Service	Stainless Steel		Sour Service	
		ASTM	ASTM	GOST	ASTM	GOST	ASTM	GOST
1	Body	ASTM A216-WCB	ASTM A352-LCB A350-LF2	20 ГМЛ, 20 ГЛ	ASTM A351-CF8M	10X17H13M2T, 08X18H10T	ASTM A216-WCB	09Г2С, 20ГА (S+P ≤ 0,03%)
2	Closure	ASTM A216-WCB	ASTM A352-LCB A350-LF2	20 ГМЛ, 20 ГЛ	ASTM A351-CF8M	10X17H13M2T, 08X18H10T	ASTM A216-WCB	09Г2С, 20ГА (S+P ≤ 0,03%)
3	Ball	ASTM A105/ENP	ASTM A182-F216 A350-LF2 + ENP	A350-LF2 + ENP	ASTM A182-F316	10X17H13M2T, 08X18H10T	ASTM A105/ENP	A350-LF2 + ENP
4	Top Flange	ASTM A216-WCB	ASTM A216-WCB	09Г2С	ASTM A351-CF8M	08X18H10T	ASTM A216-WCB	09Г2С (S+P ≤ 0,03%)
5	Gasket	316ss + Graphite	316ss + Graphite	S.S. + Graphite	316ss + Graphite	S.S. + Graphite	316ss + Graphite	S.S. + Graphite
6	Seat	PTFE, PEEK	PTFE, PEEK	PTFE, PEEK	PTFE, PEEK	PTFE, PEEK	PTFE, PEEK	PTFE, PEEK
7	Stem	ASTM A182-F6a	ASTM A182-F316	40X+Cr	ASTM A182-F316	10X17H13M2T, 08X18H10T	ASTM A182-F6a	09Г2С+Cr (S+P ≤ 0,03%)
8	Gland	ASTM A276-420	ASTM A182-F316	40X+Cr	ASTM A182-F316	10X17H13M2T, 08X18H10T	ASTM A276-420	09Г2С+Cr (S+P ≤ 0,03%)
9	Packing Set	PTFE	PTFE	PTFE	PTFE	PTFE	PTFE	PTFE
10	Thrust Washer	PTFE	PTFE	PTFE	PTFE	PTFE	PTFE	PTFE
13	Body Stud	ASTM A193-B7	ASTM A320-L7M	30XMA	ASTM A193-B8	10X17H13M2T, 08X18H10T	ASTM A193-B7M	30XMA
14	Body Nut	ASTM A194-2H	ASTM A194-7M	30XMA	ASTM A194-8	10X17H13M2T, 08X18H10T	ASTM A194-2HM	30XMA
15	Bolt	ASTM A193-B7	ASTM A320-L7M	30XMA	ASTM A193-B8	10X17H13M2T, 08X18H10T	ASTM A193-B7M	30XMA
16	Key	Carbon Steel	ASTM A182-F304	40X	S.S.	40X	Carbon Steel	40X

## Two-piece, floating ball valve

### DIMENSIONS AND DRAWING

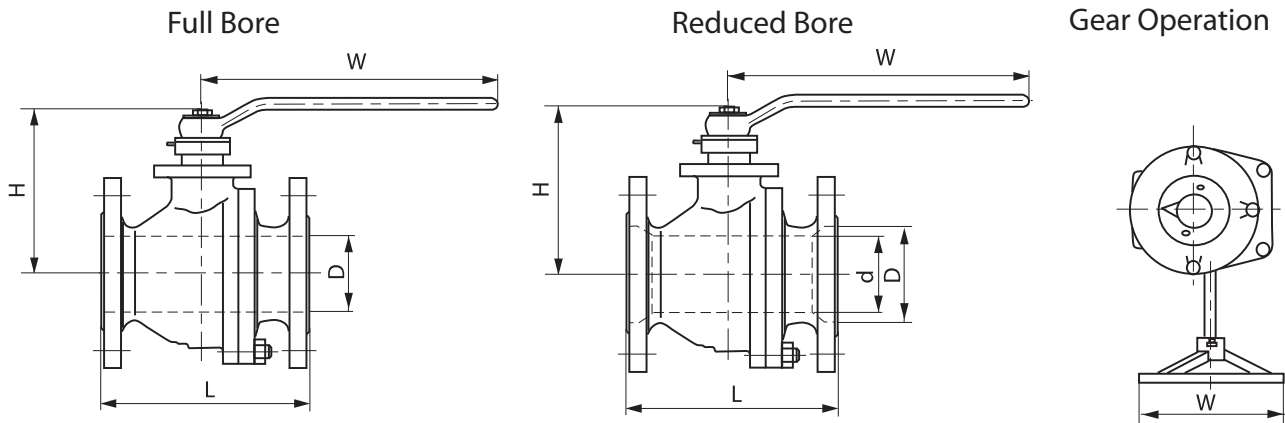

### Class 150

Full Bore							
NPS, in	D, mm/in	L-RF, mm/in	H, mm/in	W, mm/in	Weight, kg/lb	Operation	Torque N.m/lbf.in
2	51/2	178/7	107/4.2	230/9	9.5/20.9	Hand Wheel	72/637.3
3	76/3	203/8	152/6	400/15.75	19/41.8	Hand Wheel	130/115
4	102/4	229/9	178/7	700/27.6	33/72.6	Hand Wheel	154/1363
6	152/6	394/15.5	272/10.7	300/11.8	93/204.6	Gear	662/5859
8	203/8	457/18	342/13.5	300/11.8	160/352	Gear	1209/10700
10	254/10	533/21	345/13.6	400/15.75	200/440	Gear	2415/21370
12	305/12	610/24	479/18.6	600/23.6	346/761.2	Gear	6040/53460

Reduced Bore								
NPS, in	d, mm/in	D, mm/in	L-RF, mm/in	H, mm/in	W, mm/in	Weight, kg/lb	Operation	Torque N.m/lbf.in
4x3x4	76/3	102/4	229/9	162/6.4	400/15.75	33/72.6	Hand Wheel	105/929.3
6x4x6	102/4	152/6	394/15.5	191/7.5	460/18.1	58/127	Hand Wheel	187/1655
8x6x8	152/6	203/8	457/18	290/11.4	300/11.8	93/204.6	Gear	610/5399
10x8x10	203/8	254/10	530/21	340/13.4	300/11.8	160/352	Gear	2012/17810
12x10x12	254/10	305/12	610/24	442/17.4	400/15.75	230/506	Gear	5400/47790

## Two-piece, floating ball valve

### DIMENSIONS AND DRAWING

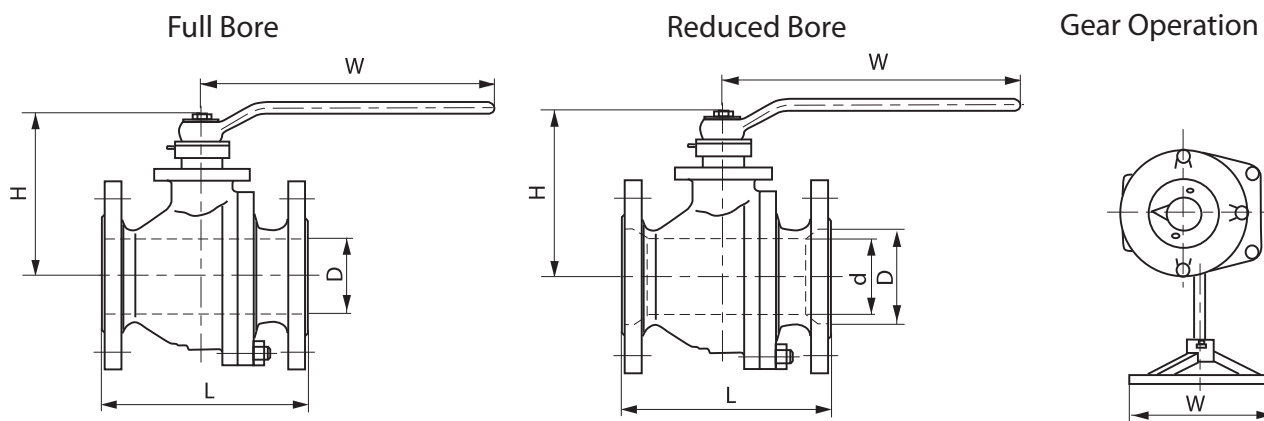

### Class 300

Full Bore							
NPS, in	D, mm/in	L-RF, mm/in	H, mm/in	W, mm/in	Weight, kg/lb	Operation	Torque N.m/lbf.in
2	51/2	216/8.5	107/4.2	230/9	15/33	Hand Wheel	98/867.4
3	76/3	283/11.1	152/6	400/17.75	35/77	Hand Wheel	141/1248
4	102/4	305/12	178/7	700/27.6	56/123.5	Hand Wheel	270/2390
6	152/6	403/15.8	272/10.7	300/11.8	116/255.2	Gear	1017/9001
8	203/8	502/19.8	342/13.5	400/17.75	233/512.6	Gear	2111/18680
10	254/10	568/22.4	345/13.7	400/17.75	433/952.6	Gear	5425/48020

Reduced Bore								
NPS, in	d, mm/in	D, mm/in	L-RF, mm/in	H, mm/in	W, mm/in	Weight, kg/lb	Operation	Torque N.m/lbf.in
4x3x4	76/3	102/4	305/12.1	162/6.4	400/17.75	55/121	Hand Wheel	150/1328
6x4x6	102/4	152/6	403/15.9	191/7.5	460/18.1	81/178.2	Hand Wheel	287/2540
8x6x8	152/6	203/8	502/19.8	290/11.4	300/11.8	118/259.6	Gear	1017/9001
10x8x10	203/8	254/10	568/22.4	340/13.4	400/17.75	200/440	Gear	5125/45360